

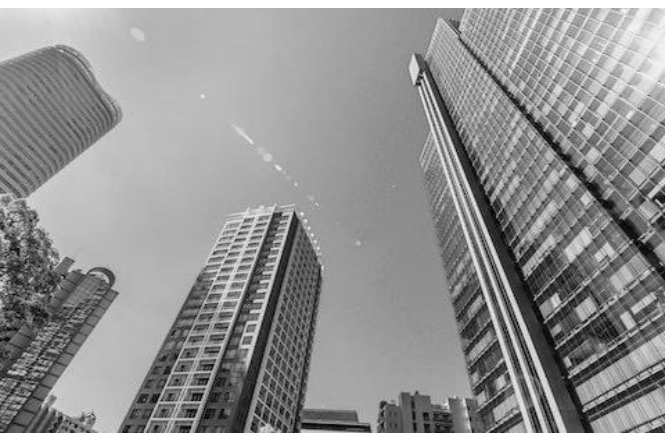

Capacity Statement



content



The Journey so far..

2009

The Journey Started

Founded by Dhruv & Anurag,
USAID funded energy tools
EcoNirman and EcoBench



2010

Reached A Global Stage

International Project (SKC South Korea)
UK ECBC Development



2011

ECBC Development

UP and Assam ECBC
CPWD: IIT Delhi LT Complex



2012

50+ Global Project

50 projects
Residential Mapping study for SDC



2013

Smart Meter Technology

HEMS with Panasonic
Prepaid Dual Source Meter



2014

Bangladesh Operations

Bangladesh Office Started
Registered as BEE ESCO, 100 Projects Milestone



2015

New Zealand operations

250 Projects
Started NZ operations



2016

Power plant projects

Kolkata office started
Integrated design of 5 Power Plant Projects



2017

Operation Expansion

Mumbai Office Started
UP, UK, WB, TN ECBC Cells



2018

Skill Development

Crossed 500+ projects
400 Programs BEE Refresher Course



2023

Operation Expansion

Chennai Office started,
DISCOMs, MSME, Appliances EE, 900 projects



2025

Target

1500+ projects
Establish as CleanTech Firm



Advisory board & core team



R K Chugh

Advisor
Past President – IEEMA
Smart Grid & Power



Pradeep Kumar

Advisor
Intl. Consultant on EE &
Climate Change



Anurag Bajpai

IIT Roorkee
Sustainable Design &
Implementation



Dhruv Jain

IIM Ahmedabad
Products & Solutions



Samvedana

IIT Roorkee
Technology Enabler



Vinod Kumar Singh

IIT Roorkee
Lead Architect and
Planner

Credentials

900+

**Projects
Globally**

03

ECBC Master
Trainer

03

Certified M&V
Professionals

14

Energy
Auditors

18

IGBC APs

100+

**Strong
Technical Team**

11

LEED Aps & GAs

12

GRIHA CP &
Evaluators

02

EDGE &
WELL APs

02

ESTIDAMA /
Pearl PQP/ GSAS

**50+ Certified
Professionals**

GreenTree Global: Four Verticals



Industries

- DISCOMs – DSM Implementation
- MSMEs- Technology Replacement and Financing
- Appliances- Cooling & Refrigerants
- Smart Metering

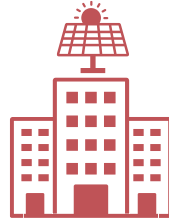

Buildings

- New & Existing Building Efficiency- Design Development
- Green Building Certification, Testing, Cx
- Energy Retrofits & ESCO
- ECBC, Net Zero, GHG, & LCA
- ESG Integration, EHS
- Air Pollution

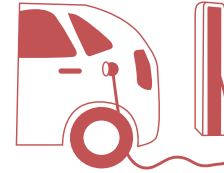

Mobility

- Market Research
- Design And Development- EV Charging Infrastructure
- Collaboration with MGL
- EV adoption at City Level



Education

- GT Academy
- Lab Setups
- Excellence Centre Establishment
- Curriculum Development

Industries



DISCOM – DSM Implementation

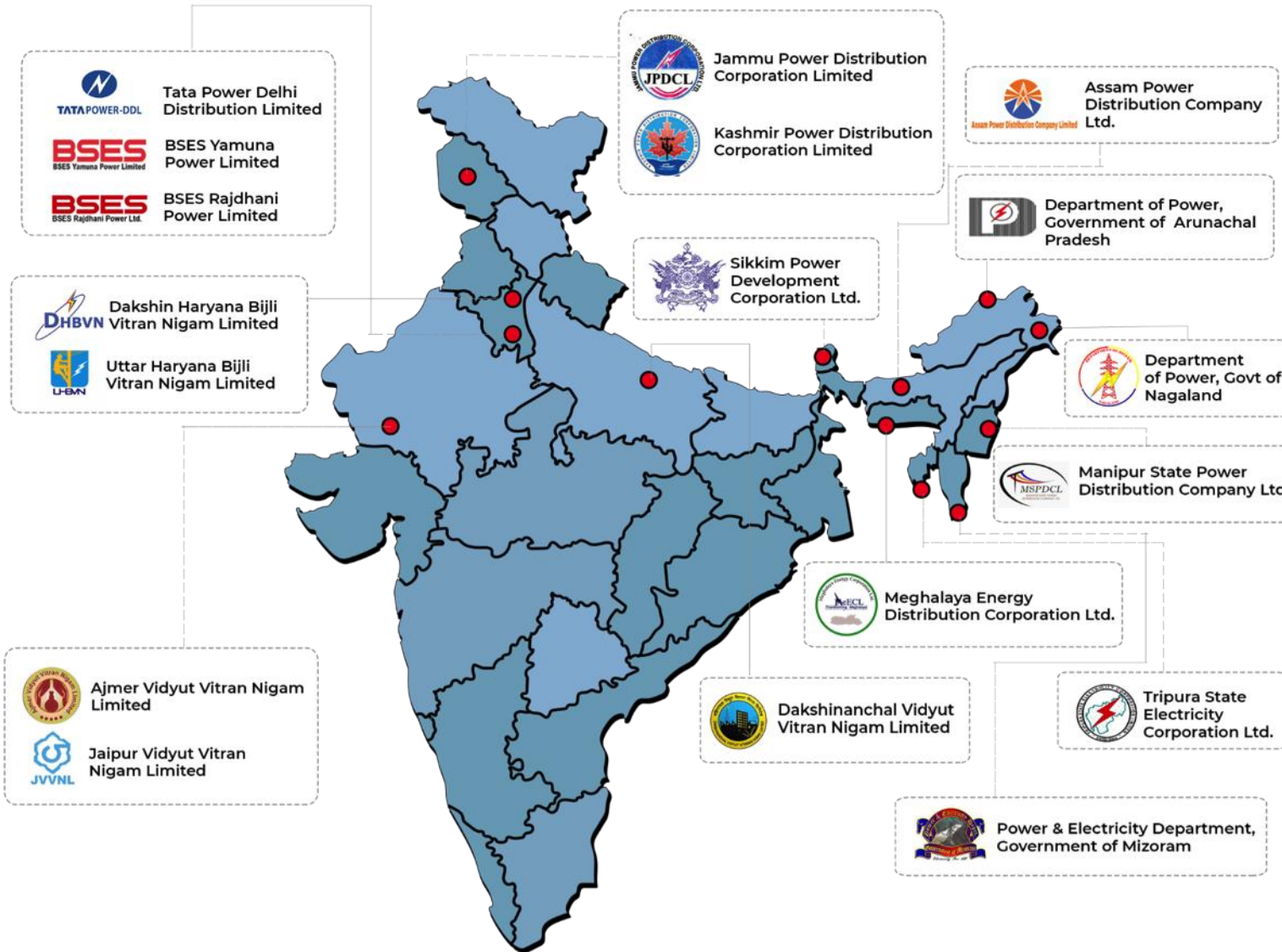

Project	Capacity Building of DISCOM
Zones	North and North East
States	Jammu & Kashmir, Delhi, Haryana, Rajasthan, Uttar Pradesh, Sikkim, Assam, Meghalaya, Tripura, Arunachal Pradesh, Mizoram, Manipur and Nagaland
Duration	2 Years
Stakeholders	Distribution Companies (DISCOM), SDAs, SERC, OEMs
Client	Bureau of Energy Efficiency (BEE)



Client: BEE

MSME: Technology Replacement and Financing



Project	Empowering the MSME Sector: Capacity Building Training Project
Description	The Capacity Building Training Project in Banking, executed by the Bureau of Energy Efficiency (BEE) in collaboration with UNIDO and funded by GEF, focuses on fostering dialogue among local bankers, entrepreneurs, and stakeholders regarding financing new and improved technologies in the MSME sector. It encompasses five key sectors and conducted 25 Capacity Building Training Programs across multiple states, engaging over 220 banks and more than 2000 participants, including major banks such as Axis Bank, HDFC Bank, ICICI Bank, State Bank of India, and others.



Client: BEE

MSME: Technology Replacement and Financing



Project	Boosting MSME Growth: B2B Exhibition Project
Description	The B2B Exhibition Project for MSMEs stands as a strategic initiative aimed at fostering the adoption of energy-efficient and renewable energy technologies within energy-intensive industrial clusters, primarily comprising Micro, Small, and Medium Enterprises (MSMEs). Supported by the Ministry of Micro, Small and Medium Enterprises (MoMSME) and the Ministry of New and Renewable Energy (MNRE), the project operates in 15 locations across India, spanning the sectors of Ceramics, Dairy, and Hand Tools. It facilitates vendor interface activities, showcasing over 200 stalls for EE/RE technologies, with active participation from more than 2000 MSME units and collaboration with prominent industry players.



Client: BEE

Appliances- Cooling & Refrigerants

Project	GreenTree and Market Xcel will produce two technology roadmaps outlining efficiency targets, scenario analyses, and necessary steps, including research, skills development, and policy support.
Objective	To align stakeholders and set long-term energy efficiency standards for air conditioners and ceiling fans in accordance with the India Cooling Action Plan (ICAP) by 2030.
Client	Natural Resources Defense Council (NRDC)



Project	Joint Survey for BBMP Street Light Project
Description	This project involves the launch and finalization of an Action Plan for a Joint Survey, outlining the sequence for surveying sections/zones of the Public Lighting Network. Stakeholder inputs, team formation, asset surveys, and data compilation are key components.

Project	Dry Type Transformer
Description	This project explores the growing Dry Type Transformer (DTT) market, driven by government initiatives, electrification, and infrastructure investments. DTTs, with air cooling for safety and cost-efficiency, are replacing traditional transformers. The project provides insights for industry stakeholders.

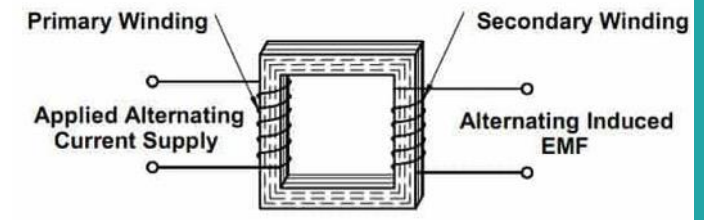

Smart Metering

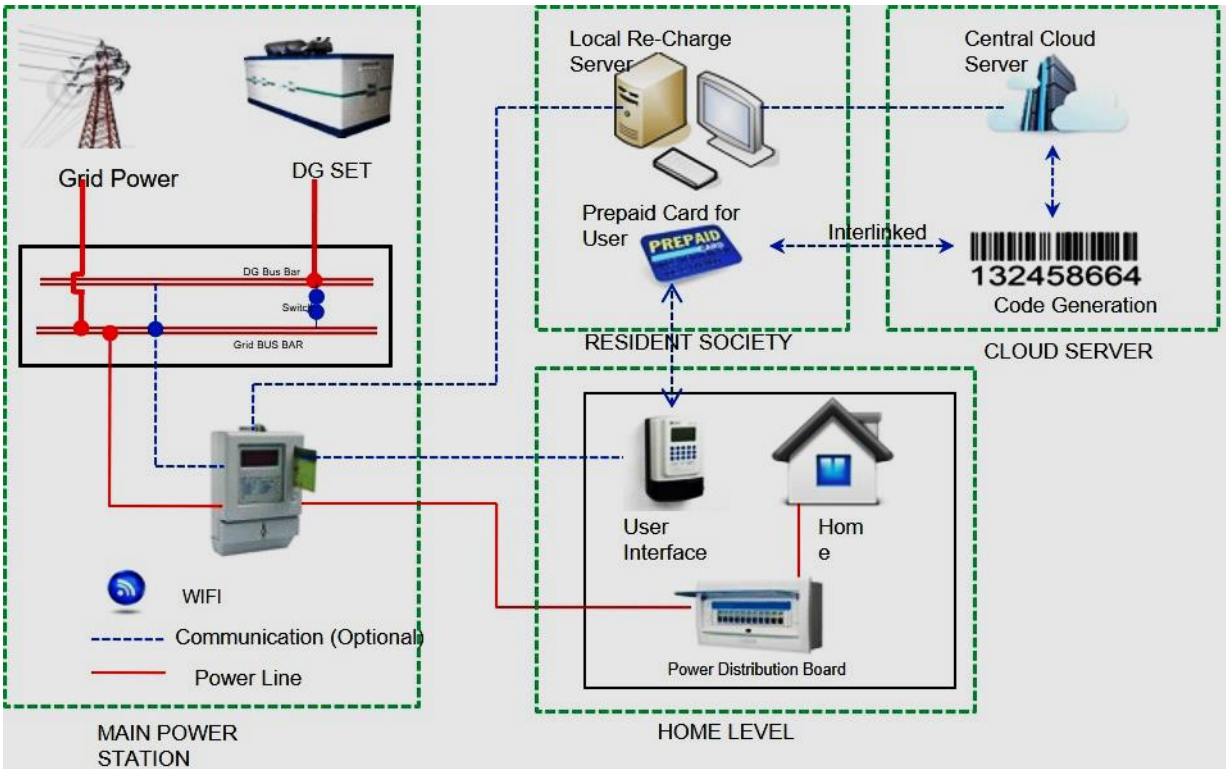

Schematic Illustration of Metering & Billing Solutions

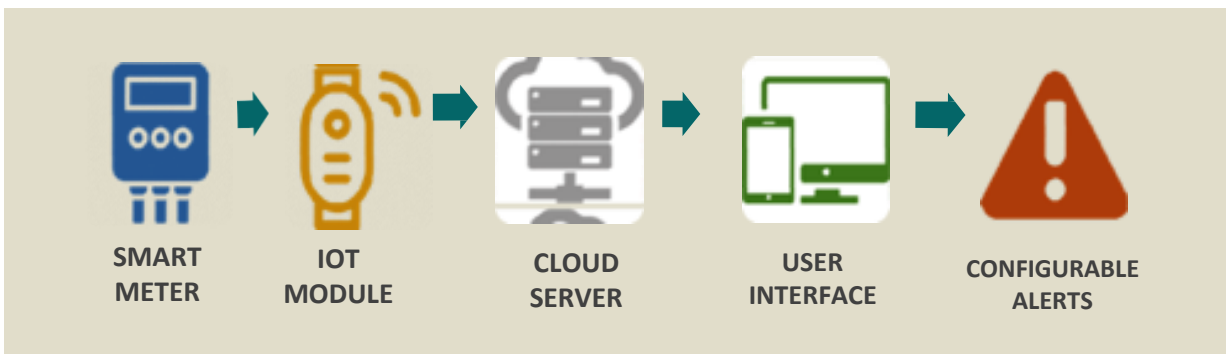

Dual Source Prepaid Energy Meters

Real time Energy Consumption in Watts/hour

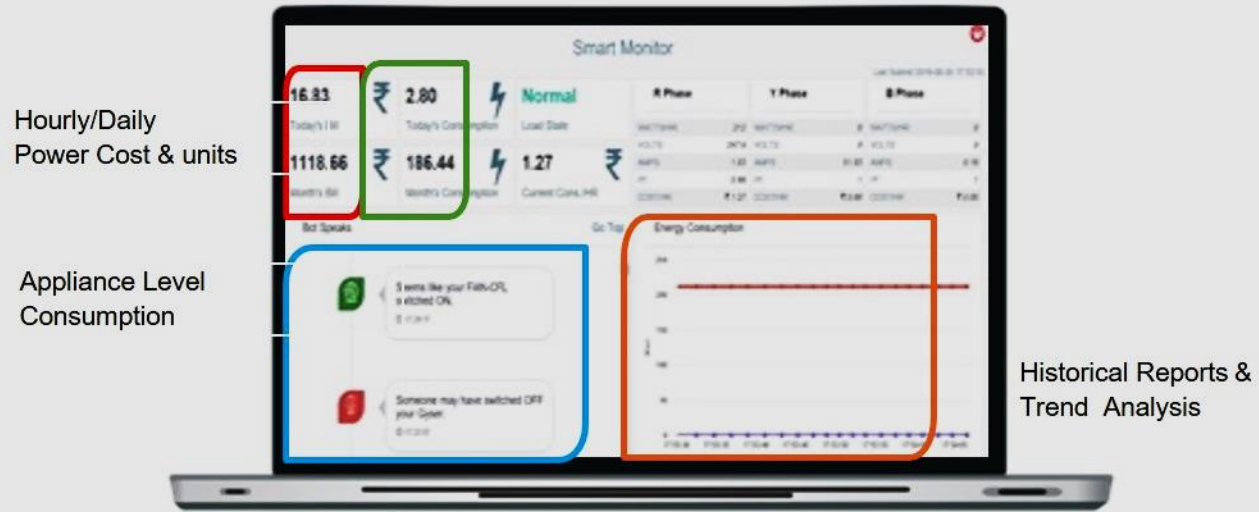

Smart Metering

ECOnirman & ECObench Tools

USAID INDIA Building Energy Tools

ECBC Conformance Check Tools **Energy Benchmarking**

ECO nirman **ECO bench**

Online ECBC Conformance Check using the Prescriptive and Whole Building Performance Methods

Building Energy Benchmarking

Remote Telecom Tower Management

GRIDSYNCH Energy Solutions

TeleSynch

Cypress *Winning the Best*

HOME, SITE DELIVERY, SYSTEM MONITOR, TOWER BUSINESS, ALARMS, MANAGEMENT OFFICE, SETTINGS

BY SITE MONITOR BATTERY STATUS

DETAILED RESULTS

SOME USEFUL PRODUCTS

Pre-paid Meters

GRIDSYNCH *Simply Smarter*

Projects > India > Maharashtra > Mumbai > Brigade Tower > Real Data

Customer Data, Tariff Data, Vending Data, Sales Data, Real Data, Billing Report, Complaints

Flat No:

Flat Number	Meter Number	Housing Type	Flat Owner	EB KWH	EB Runhrs	DC KWH	DC Runhrs	Recharge Amt
A-101	900001411	M1	Akshay Joshi	95.86	768	0	0	800
A-102	900001015	M2	Krishna kumar	12.64	367	10.6	204	1000
A-103	900001403	M3	Rohit Sharma	30.22	938	0	0	1200
A-104	900001304	M2	Deepak Tiwari	18.05	358	16.17	187	1400
A-105	900001247	M2	Mohit Gupta	0.21	723	4.73	67	1400

- Running Hours of DG and Mains Supply are provided.
- Bill recharge is possible through the RWA office and also from Mobile App

Home Energy Management Tool (HEMS)

HomeCloud Energy Management

Energy Overview, Energy Consumption, Energy Production, Energy Storage

Total Energy consumption by Circuit

Energy Monitoring & Management → Security & Communications Management → Home Automation & Controls → Billing & Sub-metering Management

Buildings



Design Developments



Project	The Million Trees
Location	Udaipur
Area	4,85,622 sq. m.
Client	Ananta Aarogya Infra Pvt. Ltd.

Project	Thermal Power Project
Location	Maitree, Panki, Karanpura, Patratu, Khurja
Area	46,300 sq. m.
Client	NTPC



Project	Kaushalya Clinic and Residential
Location	Noida, UP
Area	375 sq. m.
Client	Private

Green Ratings



Category	Residential
Project	OMAXE The Hemisphere
Rating	IGBC Green Housing



Category	Commercial
Project	POSCO Power Mirae Center, Seoul
Rating	LEED Platinum



Category	Institutional
Project	Nalanda University
Rating	GRIHA LD 5 Star*



Category	Infrastructure
Project	Leh Airport
Rating	GRIHA 4 Star*



Lucknow



Mumbai



Pune



Kanpur



Agra

Category	Green Metro Projects
Project	IGBC Green Mass Rapid Transit System (MRTS)
Rating	IGBC MRTS Platinum Rated



Category	Factory (International)
Project	Nokia Factory Building, Vietnam
Rating	LEED Silver

Energy Retrofits, LCA, GHG, and ESCOs



Schweizerische Eidgenossenschaft
Confédération suisse
Confederazione Svizzera
Confederaziun svizra



Project	Technical assistance to implement ECBC in Tamil Nadu, West Bengal and Uttarakhand
Donor Agency	UNDP

Project	Mapping & Assessment of Sustainable Building Rating Systems in India
Donor Agency	Swiss Development Agency

Project	ECBC Implementation Mapping Study & Enforcement Framework
Donor Agency	International Copper Alliance India



Project	Benchmarking study of Environmental performance of Mumbai Suburban Rail
Donor Agency	World Bank

Project	Enabling the Ecosystem to Improve Access to Green Affordable Housing for Women
Donor Agency	Asian Development Bank

Project	Mapping Study for South Asia - (Bangladesh, Bhutan, India, Maldives, Nepal, and Sri Lanka)
Donor Agency	USAID

* Used images are just for reference purpose.

Energy Retrofits, LCA, GHG, and ESCOs

Project	Involves executing energy efficiency retrofits for a government building in Rajshahi, Bangladesh. This initiative is part of the broader "Accelerating Climate Action through the Promotion of Urban Low Emission Development Strategies (Urban-LEDS II)" program.
Objectives	To enhance the energy performance of the building, contributing to a more sustainable and climate-resilient urban environment in Rajshahi.
Donor Agency / Client	ICLEI



Source: Feni Municipality



* Used images are just for reference purpose.

A close-up photograph of a blue electric car's charging port. A grey charging cable is plugged into the port, which is open. The car's body is highly reflective, showing the surrounding environment. In the background, a white charging station is visible, along with a concrete curb and a brick drainage grate. The scene is brightly lit, suggesting a sunny day.

Mobility

SIEMENS

Project	A comprehensive assessment of the Indian Electric Vehicle Charging Infrastructure market.
Objectives	<ul style="list-style-type: none">• To analyzing market potential, understanding the industry outlook, evaluating product offerings, assessing technology, and devising strategic approaches.• The project also covers pricing, company profiles, policy and regulatory analysis, and concludes with strategic recommendations.
Client	SEIMENS

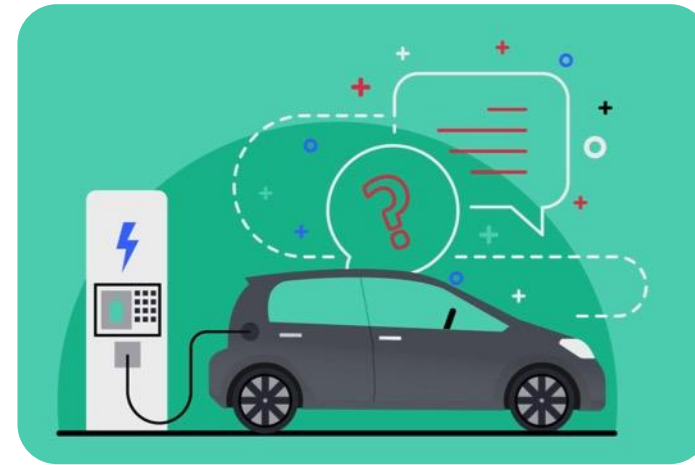

Design And Development

Typical Charging Infra Schematic View

ILLUSTRATIVE

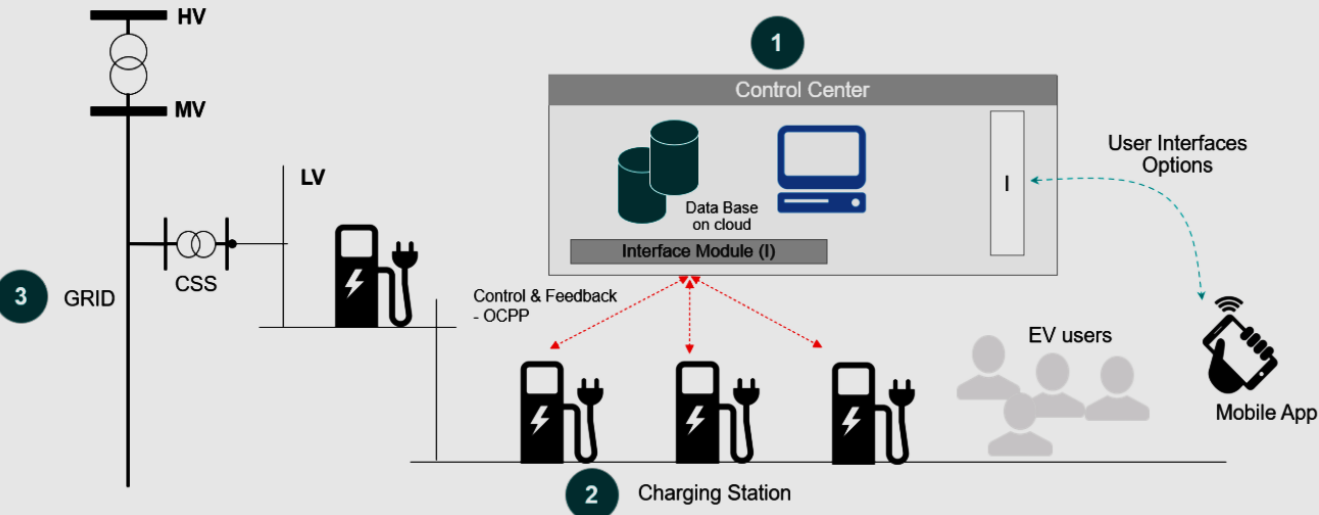

Development of e-Mobility program and adoption plan for Kakinada municipality Capacity building of students, entrepreneurs, and local self-help groups.

1550+ potential participants out of which 550+ vehicle users, drivers, entrepreneurs, and students were trained

Donor Agency/Client: UK-Pact

Government Officials e-Vahanam tool development information aggregation portal

Designed to create awareness about climate change, and sustainability through e-vehicles and empower communities

Donor Agency/Client: UK-Pact

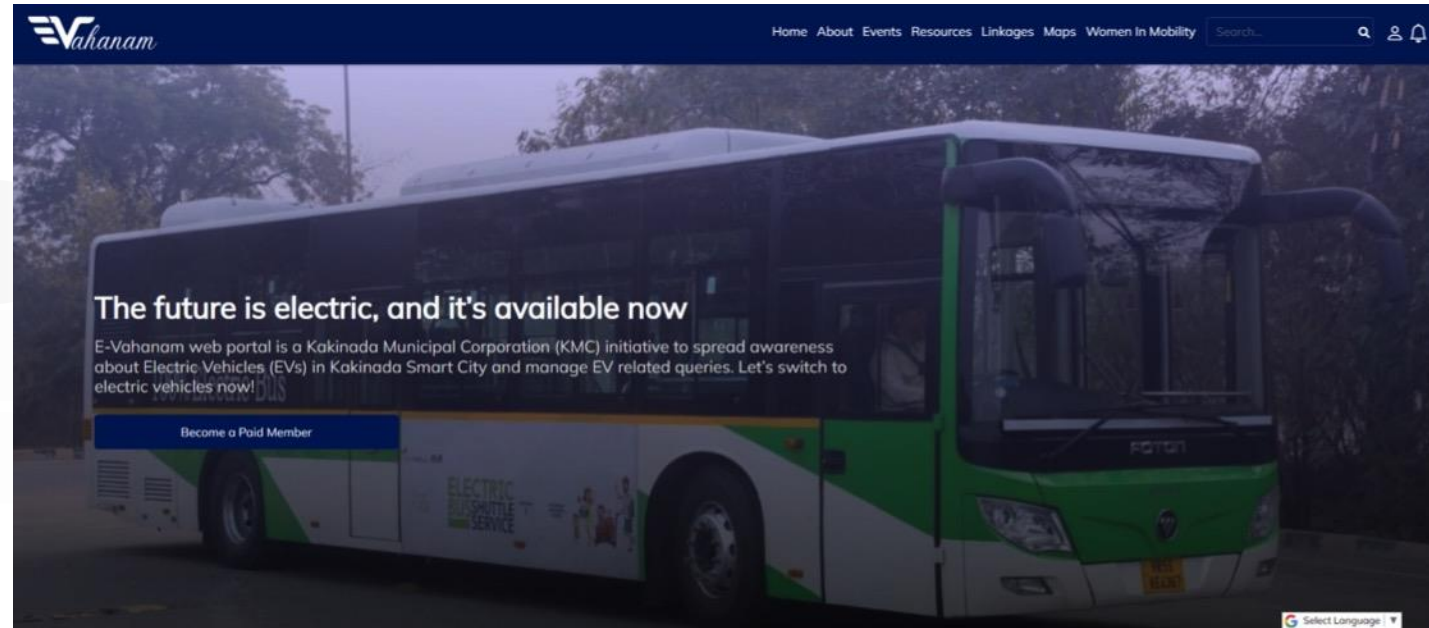

Collaboration



In collaboration with MGL Microgrid Lab as a technical partner, GreenTree Global is well-prepared to make significant advancements in the mobility sector. This strategic partnership brings together expertise and innovation to drive sustainable solutions and enhance the future of mobility.

Education



GT Academy



Course	ESG Compliance
Duration	3 Weeks
Proficient for	Students and Professionals in the area of Sustainability



Course	EA/EM Preparatory Course
Duration	5 Weeks
Proficient for	Professionals from diverse fields



Course	GRIHA CP
Duration	4 Weeks
Proficient for	Professionals from diverse fields



Course	Data Analytics
Duration	12 Weeks
Proficient for	Engineers, Sustainable enthusiasts, Energy analysts, Green Building Consultants, working professionals, etc.

GT Academy

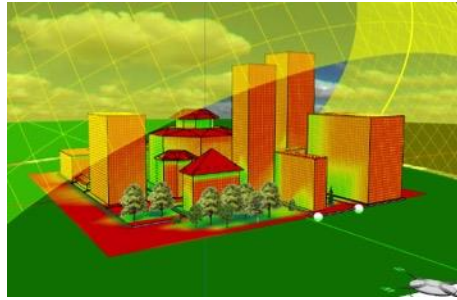

Course	Energy Simulation & Analysis
Duration	6 Hours
Proficient for	Architecture/ Construction/Energy Studies



Course	Sustainability Management in Buildings
Duration	12 Weeks
Proficient for	Architects, Engineers and management Professionals working in the Sustainability Sector



Course	Placement Assistance Program
Duration	12 Weeks
Proficient for	Early Stage Professionals, Sustainability Enthusiasts, Final Year students of Architecture and Engineering

Workshop / Skill Development



Course	Refresher Course Program
Duration	2-day training (includes an assessment/exam)
Proficient for	Certified Energy Auditors and managers for renewal of their certificates.

Workshops, training sessions, and skill development programs for the relevant professionals for energy efficiency, low-carbon innovations, EV infrastructure etc.

GreenTree Global: Awards & Recognitions



Public & Private
Sector

- Department of Science & Technology, Times of India, CIIE- Top 50 innovation Award in India
- Industry Excellence Award by Institute of Economic Studies, New Delhi
- Energy Conservation Award (Uttar Pradesh) 2017 & 2018

- ECBC Envelop Committee Member
- Silver Membership USGBC
- BEE Registered ESCO
- Member IGBC
- Rated Projects: 21 Platinum, 62 Gold
- Max fast track projects- GRIHA 2023 Award

- BEE Empanelled Net Zero Design Consultant
- Founding Member: IBPSA India
- BEE Empanelment ECBC Expert Consultant
- GRIHA Patron
- Core Committee Member-SEEM
- Core Committee Member – IGBC Western UP Chapter
- IGBC Premier Consultant – Residential

విజయవాడ విమానాశ్రయం
विजयवाडा हवाईअड्डा
VIJAYAWADA AIRPORT

GAPS | DISCUSSIONS | IDEAS

To Know More, Reach out to us at:



NOIDA OFFICE

GreenTree Global
B-67, Sector 67, Noida-201301,
Uttar-Pradesh, India
+91-120 230 3529
+91-9811122522



GUWAHATI OFFICE

2ND Floor, Varda House,
Near Santipur Sluice Gate
R K Choudhury Road
Bharalumkh Guwahati - 781009
+91-9811122522



MUMBAI OFFICE

GreenTree Global
808, Goodwill Infinity Sector-12,
Kharghar, Navi Mumbai- 41021
+91-9967098721



PANCHKULA OFFICE

GreenTree Global
House No 270, Sec- 18,
Panchkula-134109, Haryana
+91-9915528654



LUCKNOW OFFICE

GreenTree Global
276, Hind Nagar, Kanpur Road,
Lucknow-226012, UP, India
+91-9811122522



DHAKA OFFICE

Civil Swapnil, 465/30, Level B1
Bondhu Nibash, West Rampura
Dhaka 1219, Bangladesh
+88-01713462440



CHENNAI OFFICE

Second Floor, Platinum Jubilee building, AC
Tech Campus, Anna University, Guindy,
Chennai, Tamil Nadu 600025
+91-9810386609